

CAMOUFLAGE NET WORK BEGINS

*Rivers Cities
Near Capacity*

*Work Limited To Citizens Only;
One Thousand Workers Sought*

Contingents totaling 1,433 persons made their entry into Rivers on October 17, 18 and 19. Expecting 250 special clean-up workers still stationed in Santa Anita, there are no further movements booked for this community.

On Saturday, October 17, 220 Stocktonians and 156 Fresnoans began the last mass induction. They were followed on Sunday and Monday by 553 and 514 Santa Anitans.

ARRIVAL DELAYED

The Monday movement was delayed by a freight wreck on the tracks ahead, the last busload going through the induction station at 12:30 a.m., full five hours behind schedule. Sunday's arrivals were greeted by the first combined dust, wind, and rain storm that Rivers has experienced in months. Baggage crews and housing workers worked overtime on both nights to make the new arrivals comfortable.

MANAGERS SELECTED

The three groups moved into blocks 28, 29, 30, 31, 32, 33, 34 and part of 36 in Butte. New Block Managers have been selected for all except 36. They are block 28, Tomoko Kawakami; 29, Henry Laebe; 30, Kozuma Chogyaji; 31, Jack Kawai; 32, Frank Kobata; 33, Harry Sumi; 34, Seichi Takeda.

MARINE VISITS RIVERS FRIENDS

Sergeant Glenn Abbott, U.S. Marine, was here recently visiting friends.

Abbott visited the Sameshimas and Yuges in Butte and the Sasakis in Canal. He is studying Japanese at the San Diego Marine Corp. School. He first began his education in Japanese language as a youth when he attended the language school in Pomona.

Camouflage net project, one of the largest projects in the Rivers Communities, started its initial garnishing work yesterday. Thomas Reynolds is WRA net project manager.

One garnishing shed is completed and four others, along with a warehouse, are nearing completion. The foundation for the cutting shed has been laid. Buildings are scheduled to be completed the first week in November revealed Lieutenant B.N. Frykland, area engineer.

Gila Chapter of JACL Assured

A Gila Chapter of the Japanese-American Citizens League was assured last Sunday when representatives of 12 former chapters met to formulate plans of the organization.

Based upon the national constitution, a set of by-laws to govern the Gila Chapter will be drafted tonight. Members of this committee are N. Kawai, J. Nakamura, T. Hirashima, H. Terazawa, and Dr. E. Yusa.

All past and present officers of JACL are invited to meet this Sunday at 2 p.m. in 42-5-A to approve the constitution and aid in the formulation of local policy.

To create interest in the coming general election, a parade was held last evening with the aid of the Boy Scout Drum and Bugle Corp.

Large portions of the membership in this colony are from Alameda, Contra Costa, Fresno, Longoc, Parlier, Pasadena, San Gabriel Valley, San Luis Obispo, Santa Barbara, Santa Maria, Ventura, and Yolo-Solano.

FRIEDMAN FILLS POST AT CANAL

Samuel D. Friedman, acting placement officer for Canal, arrived October 16 from Tule Lake project to fill the vacant post. He will work under John C. Henderson, project supervisor of housing and employment.

CANAL AND BUTTE WORKERS

William Huso, placement officer, stated that work will be limited to citizens with two hundred workers from both communities to be placed very soon. After the completion of the buildings, it is estimated that almost 1,000 workers can be employed. Seventy per cent of this total may be women.

MACHINERY USED

The five garnishing sheds will have five stations each. Stations are equipped for 32 garnishers, with one foreman. The machinery for lowering and raising the nets have been devised for the convenience of workers. Here garnishers will weave burlap strips (strips are in nine different colors) into ordinary fishing nets. The size of nets to be garnished here are 33'x44' and 33'x60'.

The cutting shed where the strips will be cut down to proper width and length will employ 40 cutters, two foremen and one general superintendent.

Class To Train Teachers Open

The Canal Education Department desires four or five young men or women with two or more years college training to attend our Teachers Training classes, from 8 to 9, Monday, Wednesday, and Friday mornings. Apply at 13-1-A as soon as possible. This offers real opportunity!

GILA News-Gouquier

Published every Wednesday & Saturday
Distributed without charge to every room
Extra copies available at News Office

Editorial & Business Office: 57 News Room

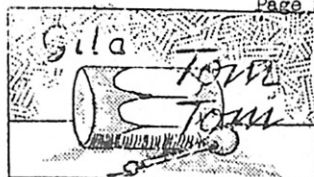

Why aren't the Gila residents supplied as yet with stoves of one type or another? The aged, the sick, and babies should not suffer through the chilly mornings which have come upon us so suddenly.

U.K.

Residents need not fret. There are heaters in the warehouse ready for installation when the mornings really become cold. Extra coverings are obtainable, so the aged and the very young need not suffer. The really sick can obtain proper care through the proper channels.

Those who think it is cold should compare the following figures* and then pause to wipe the perspiration from their brows.

The following high and low temperatures are from a booklet issued by the WRA.

	max.	min.
Tule Lake	99	*27
Colo. River	120	9
Gila River	117	9
Minidoka	104	*30
Central Utah	106	*30
Heart Mountain	100	*40
Granada	110	*25
Rohwer	112	*6

* designates below zero

We pass by letters de-
crying bathroom baritones,
soap sud sopranos who ex-
ercise their vocal chords
at night to disturb the
slumbers of early sleep-
ers. We know that such
grievances will be righted
by time.

We stop to assure Santa
Anitans that Rivers is a
very seldom visited by such
storms as they experienced
on their arrival here. We
can bear accurate witness
to the fact that conditions
are immeasurably better
here now than they were
when we first came.

We hope that readers
who are unable to spot
news of their own camp
will be aided in so doing
by the letters B. and C.
and G. before each article,
indicating Bents, Canal
and General news respec-
tively.

Cacti Cutters Cautioned

The two most picturesque things of Arizona are the gorgeous sunsets and the stately cactus plants which are symbolic of Arizona as are the fields of golden poppies of California. Both the sunset and the stately cactus plants are like the work of God in this country; awe-inspiring to all who look upon them. The sunsets...man cannot destroy. But the great cactus plants which rear like giants into Arizona's picturesque skies...and which have taken many years to make their almost painfully slow growth can be cut down by man with a few swift blows of a sharp instrument.

The stately cactus on the nearby hills add much to the surroundings of our new homes. When the days of peace come again and we leave here let us leave these cactus plants as they are today---standing in all their splendor and not dead...rotted things on the ground.

T.H.

WRA Communities Compared

Name	County	State	Capacity	Acres	Agri. Acres
Manzanar	Inyo	Calif.	10,000	6,000	500
Tule Lake	Modoc	Calif.	16,000	26,000	24,000
Colo. River	Yuma	Ariz.	20,000	72,000	41,000
Gila River	Pinal	Ariz.	15,000	16,467	14,750
Minidoka	Jerome	Idaho	10,000	68,000	17,000
Central Utah	Millard	Utah	10,000	19,000	10,000
Heart Mount.	Park	Wyo.	10,000	45,000	28,000
Granada	Prowers	Colo.	8,000	10,000	6,500
Rohwer	Desha	Ark.	10,000	10,000	9,000
Jerome	Chicot	Ark.	10,000	9,500	8,500
	Drew				
Total.			119,000	282,867	157,250

Rivers Residents Absolved

The attempt to recruit Japanese evacuees for picking Arizona long-staple cotton was dismissed as a "noble experiment" by an investigating committee from the Arizona Farm Bureau Federation.

Less than 300 evacuees from the Gila relocation center near Sacaton have been in the fields any day since the experiment began Sept. 21 under a special dispensation from the United States Army. 90 growers of 107,500 acres in areas opened by the Army dispensation must look elsewhere for harvest labor.

They are unsure how much they can gather of this crop, which has been reserved for glider, airplane and similar military goods.

The committee's statement absolves the Japanese from blame for the failure.

Washington estimated that 3,000 Japanese pickers would be available from the Gila center. They spoke, it is charged, without knowledge of projects which the War Relocation Authority had already started in order to make the center self-reporting.

Of the center's present population, totaling 11,600 only 4211 are employable.

All but 311 of those employable are at work in camp administration and improvement or in agricultural enterprises.

(Reprinted from October 1954 issue of Los Angeles Times)

ATTENTION!**Ex Pasadenans**

Activities designed to be of definite value for former residents of Pasadena are being planned by interested organizations and friends of that city according to a communication received by Nobu Kawai this week.

In order to benefit from the work of this group, former Pasadenans are urged to leave the following information with their block manager:

1. Name of each member of the family.
2. Age and sex of each member of family.
3. Present family address.
4. Former Pasadena address.

This information must be in before noon on Saturday, October 24.

PREP PAPER

Future educational items will appear in the high school paper, edited and published by students under the direction of Leonard Schulman.

New Councilmen

Two new councilmen, Yoshimi Hirooka and Masatoshi Seki of blocks 21 and 20 respectively, were recently inducted into the Canal Community Council.

Trio to Depart

Latest Butte citizens to be relocated are Lorraine, Pauline, and Emma Masagawa, departing this week from the Gila colony to Abilene College at Abilene, Texas.

HELP WANTED**G CHICAGO, ILLINOIS**

Two young men or a couple for restaurant help.

A couple without children for employment in a home for Old People.

DES MOINES, IOWA

A girl for family of 3; \$8 a week or more.

A couple for Banker's home; \$90 month or more.

Those interested are requested to contact Rev. K. Tajima, 49-2-A.

LEAVE RULES**WAIT CLEARANCE**

Leave regulations applicable to evacuees in relocation centers lately published in the Pacific Citizen are not effected as yet, disclosed Robert Petrie, executive assistant to regional director.

The regulation provides authority under which the WRA can issue permits to evacuees to leave the colony. Operating instruction, without which the authority is not operative, is yet to be released.

CANTEEN SALES HIGH

The first week at the block 42 canteen yielded an income of approximately \$2,909.40 in the dry goods department and \$1,100 in the shoe division, reported Jun Tegurri, manager.

CALL IN FOR TOYS GAMES

From Butte's CAS Toy and Game Loan comes a request for toys, games, or any other pastimes, broken or in good condition which are not in use. Mrs. S. Ozawa at 60-2-A will handle the toys to be donated for community service.

Thespians Elect Yamamoto Prexy

Mrs. Verlin Yamamoto was elected president of the Nisei Drama Association at the second meeting of the club on Saturday at rec. hall 50. Assisting her as cabinet members are vice-president, Henry Kawabara, secretary-treasurer.

Mary Obata and Masato Inouye will aid the cabinet in drawing up a constitution. The guest speaker for the occasion was Miss Katine Strobach, a member of the educational staff, who offered her assistance to the group.

Photos Possible

Residents desiring to have pictures taken for special occasions should contact John M. Landward, counsellor of community welfare, room 16 in the administration building.



News and views from near and far...

Greetings and salutations to a new bit of journalism that marks its path across the horizon... the Topaz Times of Topaz, Utah. Divisions of Santa Anita and Tanforan will compose a part of their colony...

A Legion Post at Simmerst, Ill., has protested the admission of evacuee students, states the Pacific Citizen.

Residents of Heart Mountain are asked not to take celotex or lumber... shake hands, brother!

Cooler weather has finally made its appearance and Anzanar comes forth with an outdoor amphitheater... fine thing!

Glass bricks are being used in Poston's Press Club... hold that rising blood pressure! Measuring 2px3x6, they were merely used for unique lighting effects in the bar of the clubroom...

To newlyweds Mr. and Mrs. Joe Oyama (nee Asumi Kawachi-both staff members of the Pacemaker) may years of happiness be with you... Keep up the good work!

Cupid Coheres Canal Couple

Yachiyo Teramoto and Tetsuzo Mori were united in a simple marriage ceremony Saturday evening at the Canal Christian Church, with Reverend R. Susu-Mago officiating. The couple was attended by Mary Mori and Jack Sasaki. Baishakunins were Mr. and Mrs. S. Nakano and Mr. and Mrs. S. Kawagoe. A reception for the newlyweds followed in mess 23.

COLLEGE LURES CAS MEMBER

Kiyoko Hosoura, active CAS staff member of Canal, left this morning for Webster Grove, Missouri to enter Webster College, a Catholic school.

The CAS members regret the loss of Miss Hosoura, who was responsible for the splendid work on the Young Peoples clubroom.

Positions Open For New Arrivals

B New arrivals from assembly centers are requested by the employment office to report for interviews.

Great demand for workers has been voiced by various projects in the community. New buildings are going up and the engineering office is in need of carpenters and other laborers. The camouflage net project has started work this week, and approximately 50-100 workers are needed now to fill the positions of weavers, warehousemen, foremen, timekeepers, reefers, and cutters. Other odd jobs will be available as the project advances.

PAY CHECKS TO BE DISTRIBUTED SOON

C Part of Canal Community's August payroll checks came in Monday, and the budget and finance section started their disbursement yesterday.

V. E. Choate, section head of budget and finance, said that he expected the July and August paychecks will be distributed this week. The checks are arriving as fast as the disbursement office in Los Angeles can make them. The September payroll is expected to be in before the end of the month.

In Appreciation

C Mrs. J. S. Gozawa, who has joined her husband, Corporal J. S. Gozawa, extends her sincere appreciation to all residents of block 4 for making her send off a grand success.

C Eddie Kasugai, manager of block 3 was appointed official translator for the Canal Housing Department by the Canal Council.

B Buddhist choir practice will be held tomorrow night at 8, 63 Buddhist Church.

B The Rev. R. Susu-Mago will speak on "Hold an Angry Tongue" at the Vesper Service tonight at Chapel 40 from 8.

UNION CHURCH DONATES TO CAS

B Butte CAS received a sum of \$75 from the Santa Maria Japanese Union Church to purchase recreation equipment for the community. The donation was obtained through the efforts of Dr. Clarence Gillett, Young Peoples Director, and the Rev. Y. Oshita of the church.

BUTTE MOVIE FRIDAY NIGHT

B Butte city's first free movie will be given Friday night, 8 o'clock at the 62 lot, with Dr. Charles Kindall of the Phoenix Methodist Church showing the picture.

The showing will consist of a comic strip, scene of Alaska travel, and other interesting short subjects. Sponsored by the Gila Christian Church, everyone is cordially invited to attend.

SHORTHAND CLASS TO OPEN SOON

C Canal shorthand beginners will meet Monday, 7 p.m. at 13-11-A, as students of economics and sociology continue enrollments begun early this week, it was announced today.

The steno class will meet Mondays, Wednesdays and Fridays with Lay Shirakawa instructing. Mr. Yoshitoku will conduct the economic group which meets on Tuesdays and Thursdays in 13-10-D.

CARD OF THANKS

C We wish to extend our sincere gratitude to our many Canal friends for their many kindnesses during our recent bereavement. Mrs. Morioka and Family

LAST RITES FOR TOJI SHINOMOTO

C Funeral service was conducted for Toji Shinomoto, 57, of block 23 at the Canal Buddhist Temple this morning from 9:30 o'clock.

The surviving members of the family are widow, Mrs. Shinomoto, sons, Masao, Kenji, Takeshi, and daughter, Sechiko.



B Since inventory is now being conducted at the Butte Library, books or magazines will not be issued until tomorrow or later. However, material may be returned from 8 a.m. to 12 noon and 1 to 5 p.m.

Three specially purchased newspaper clamps disappeared from the library last Friday, revealed Midori Morooka, head librarian. Unless they are returned, leading newspapers and center news will not be available.

Dance Troupe Present Show

B Demonstrations in correct standing, walking positions, balance in various positions, rhythm study, leg swing and lifting, are but a few of the features which will be presented at tomorrow night's Dance Group concert to be held in studio 60, commencing at 8. Yuriko Amemiya, instructress of the troupe, will perform with a part of her students, consisting of Beverly Watanabe, Miye Tachihara, Cherie Yusa and Ayako Enseki. Rivers' public is heartily invited to attend the concert.

UNIVERSITY CLUB SHOW ACTION

C The University Club will hold a program-planning meeting tomorrow night at 7:30 in the 24 Women's Club room. Dr. George Suda, Frances Onoda and Genji Kawamura will head the program committee.

Canal Calendar

- October 23- Scout Meeting, outdoor stage west of block 13, 7:30 p.m.
- October 24- Ice-breaker League Victory Dance, mess 16, 8:30 p.m. Block 7 Talent Show.
- October 25- Doubles Horse-shoe Tourney, block 27, 1 p.m.
- October 26-28- Gila Relocation Fair, Buddhist Church.
- October 31- Halloween Dance, mess 16.

CANAL RIVERS FARM MANAGEMENT BUTTE

The Farm

UNRESTED L. R. RE-
CRUITING officer is Office
Timekeeper George Kawahara.
As agricultural representa-
tive to the employment
office, George explains
the advantages of farm
life to all work aspiring
centerites.

AND LIPS STILL CUCUMBER
SMITH. Those unhelpful
volunteer helpers so taxed
the patience of Unit Fore-
man Johnny Oshige that the
centerman registered a
complaint at the Internal
Security's office. Eve-
ning harvesters are urged
to leave the "cukes" alone
if they wish to avoid em-
barrassing repercussions.

UNIT FOREMAN MRS. OMATA
lays claim to the biggest
inferiority complex of any
ag man. With fifty-five
acres of daikon acting as
a camouflage, Mr. Omata
still is wondering whether
his underpinnings will go
unnoticed.

Nurseries Grow Under Direction Of Specialists

Two nurseries, the e-
first specializing in the
growing and propagation of
shrubs, and the second in
the growing of bedding
plants are a part of the
widely diversified pro-
jects under the jurisdic-
tion of the Farm Manage-
ment. The nurseries are
operated by Fred Fujii,
and Daniel and Itero Nakata
respectively, and are
located across the canal.

"Rivers Nursery," as the
first nursery is officially
known, has already set out
several different species
of shrubs and trees in
well arranged beds for
rooting. Among the shrubs
being grown is the crypto-
stegia grandiflora, a rub-
bor plant. To date four
hundred plants of that
species have been set out
in individual cans.

Many of the workers in
these nurseries are former
cut-flower growers of
Southern California. In
order to make possible the
immediate planting of
seeds, and also to insure

Labor Shortage Hits Dehydrator

Dehydration of fruits and vegetables, the process
thereby such perishables are rendered into staple pro-
ducts, is at present, because of the war, a nation-
wide subject for discussion. Particularly interested
in that matter is the United States Army which recog-
nizes more than anyone else that modern warfare de-
pends upon extreme mobility and that the dehydration
of food consumed by the army is one prime factor in
prompting mobility.

Early plans established
by the WRA had called for
a dehydration plant to be
erected at Gila, poten-
tially Arizona's major
vegetable center. Newly
established extremes in
lumber and steel prior-
ities, however, have made
practically impossible the
construction of a WRA
sponsored plant.

At present, an outside
private firm, the Julian
Company, has petitioned
the administration for the
right to erect their own
plant, buying from the
center all surplus vege-
tables after the other re-
location projects have been
supplied. Under the plan,
labor for the construc-
tion and the mainte-

nance of this plant will
be furnished by the pro-
ject, the company paying
them prevailing wages.

The major setback to
this plan, as discussed by
the Community Council, is
the lack of enough surplus
vegetables to put the de-
hydration plant upon a
paying basis. Unless the
farm program can be ex-
panded to two and three
times their present acre-
age, there will be no
vegetables for outside use.
and unless the transporta-
tion and labor problems,
the two major bottlenecks
to a greater farm program,
can be solved, agricul-
tural expansion is at a
standstill.

Thinner Wanted

Volunteer daikon-
thinners wanted! Two to
three hours work for a
crew of five from each
block. The amount thin-
ned will be delivered to
the respective mess
halls. Bitte volunteers
contact Harry Kikuya at
Employment Office, Block
42 while Canal volunteers
will inquire at Farm Man-
agement Office, 16-7-A.
Transportation will be
furnished.

Boxes Needed

A threatened shortage
of box shooks, needed to
pack in harvested vege-
tables has prompted the
Farm Management to request
all mess halls to save
empty boxes and crates.
When such containers are
placed outside of mess
halls, centerites are re-
quested not to use them for
personal purposes.

the obtainment of proven
quality plants, a number
of them have purchased
seeds with their own funds.

FARM ACREAGE UNDER TEN HEADS

The 6,975 acres of cul-
tivable land eventually to
be placed under vegetation
are divided into ten sepa-
rate units, with a unit
foreman at the head.
These units range in size
from 200 to 1,000 acres,
depending upon location
and the type of crop the
units will produce. Fol-
lowing are the unit fore-
men responsible for the
employment of 25 to 200
men: Joe Nakada, "Tojo"
Nata, George Nakamatsu,
Harry Kikuya, Steve Umho,
Frank Matsumoto, Min Omata,
and Johnny Oshige.

RIVERS SHIPS FIRST PRODUCE

Carl Kawagoye, chief
packing house foreman,
states that vegetables to
other relocation centers
will be shipped as soon as
enough box shooks can be
made available. Beets and
turnips which will hit
harvest peak next week
will probably be Gila's
initial food contribution
to other centers.

BLOCK HEADS ANNEX CROWN

C Showing plenty of fire, dash and hustle, the spirited 23rd Block Heads emerged National League champions last Sunday in a seven inning game.

Going into the fourth frame, trailing 6-0, the slugging Block Heads blasted in nine precious runs and five more in the following to hand the gallant Scorpions a sound 16-8 beating.

Not satisfied with the National League pennant, they will tangle with the American League winners.

The Sanger Apaches who registered a close 7-8 triumph over the Solons and the improved Spitfires, who gave the Ochi Brothers a humiliating 19-7 defeat, will crossbat this Sunday for the National's fifth spot.

GILA CYCLONES MOVE CLOSER TO PENNANT

C The high riding Gila Cyclones edged closer to the American pennant by eliminating the threatening L.A. Bulldogs in a 14-12 slugfest last Sunday.

This Sunday, the winning Cyclones will face the San Jose Scrubs for the American League championship.

Fourth and fifth spot went to the Kingsburg Vikings and the Blisterbugs respectively after a drawing at a recent meeting due to the withdrawal of the Firemen and the Rough Riders from the playoff.

Sign-up for the Men's Block volleyball team has been set for this Saturday noon.

Victory Dance

C Climaxing the many weeks of vigorous competition for the National League and American League championships, an all-out Victory Dance will be held this Saturday night from 8:30 o'clock. The proceeds will go to purchasing deserving prizes for the winning teams.

Tom Ishii's Starlite Sorenaders are in top shape and will send out their best in "Sketches in Rhythm." All dance fans are urged to participate in this major activity.

News-Courier Sports

GOH TOURNAMENT STARTS SUNDAY

C The four day open Goh Tournament will get underway Friday and continue on to Tuesday at rec. hall 61.

Approximately 150 goh aspirants are having their daily practice sessions in preparation for the tourney.

Gila Sumo Kyokai Drafted at Canal

C To stimulate interest in sumo, a traditionally popular sport, an association known as the Gila Sumo Kyokai, No. 1 was organized in Canal.

Elected to the various offices are as follows: pres., Fukushima; vice-pres., Nishigima; treas., Nienikawa and Shigaki; auditors, Ishii and Ito; inspec., Kaneshige, Kubota, Nishiyama, and Tagima; sec., Inosaka; instructor, Minamide; and a council of fifty members.

A "dohyo" elevated about three foot above the ground has been constructed between block 24 and 25.

Last Saturday evening, the lightly clad sumoists put on a practice-exhibition for the huge assemblage.

SIX-MAN FOOTBALL PRE-SEASON TOURNEY

C A pre-season six-man football tournament will be held for 15 and 16 year old and 14 and under boys, starting Saturday, October 31, with the finals being played on Sunday.

The unlimited roster deadline will be October 29 at 5 p.m. For the convenience of the managers, the rosters can be handed in at either rec. hall 56, 61-12-B or 47-5-D.

BASKETBALL

ROUND UP

36 Pasadena	Turlock	33
39 Oxnard	Camp 1	23
54 Bulldogs	52 Moss	27
39 Pasadena	Dikes	32

GRID LEAGUE TO OPEN-FIRE

C Tentative plans have been set to start the six-man football league this Saturday, it was announced today by Teiji Itow, director of men's athletics.

Although the schedule may be altered, it is planned that all league teams will see action either on Saturday or Sunday.

The opposition schedule for the encounters were not available at press time.

GIRLS' SOFTBALL TO END TONIGHT

The girls' softball league will end tonight when Starlettes and Canteenettes play-off at 6:30 to determine the opponent to play the Gila Babes who at present are the league leaders.

The championship game will be played on Sunday and the winner will be awarded a box of candy with the compliments of Morton Guba.

YAMASHIRO CROWNED HORSHOE CHAMP

C Hide Yamashiro came through with a splendid record of winning twenty out of twenty-one to take the championship of the recent Round Robin Singles Horseshoe Tournament. Following closely with nineteen out of twenty-one was George Ikeda and Taro Katagiri who shared second honor. Sod Kobashi finished third with eighteen wins.

The contest and score keeping was handled by Goro Maeda and Kaz Ohara.

Lassies' Rally

C A girls' rally will be held Saturday starting at 2 p.m. at rec. hall 29.

At the time, volleyball championship awards will be presented.

All volleyball players and girls interested in sports are asked to attend.

MR. TULARE IMPROVES

C Neboru Wakamoto, better known as Mr. Tulare in barbell circles, has boosted his clean and jerk record to 235 pounds. His previous record stood at 220 pounds.

STREET

STREET

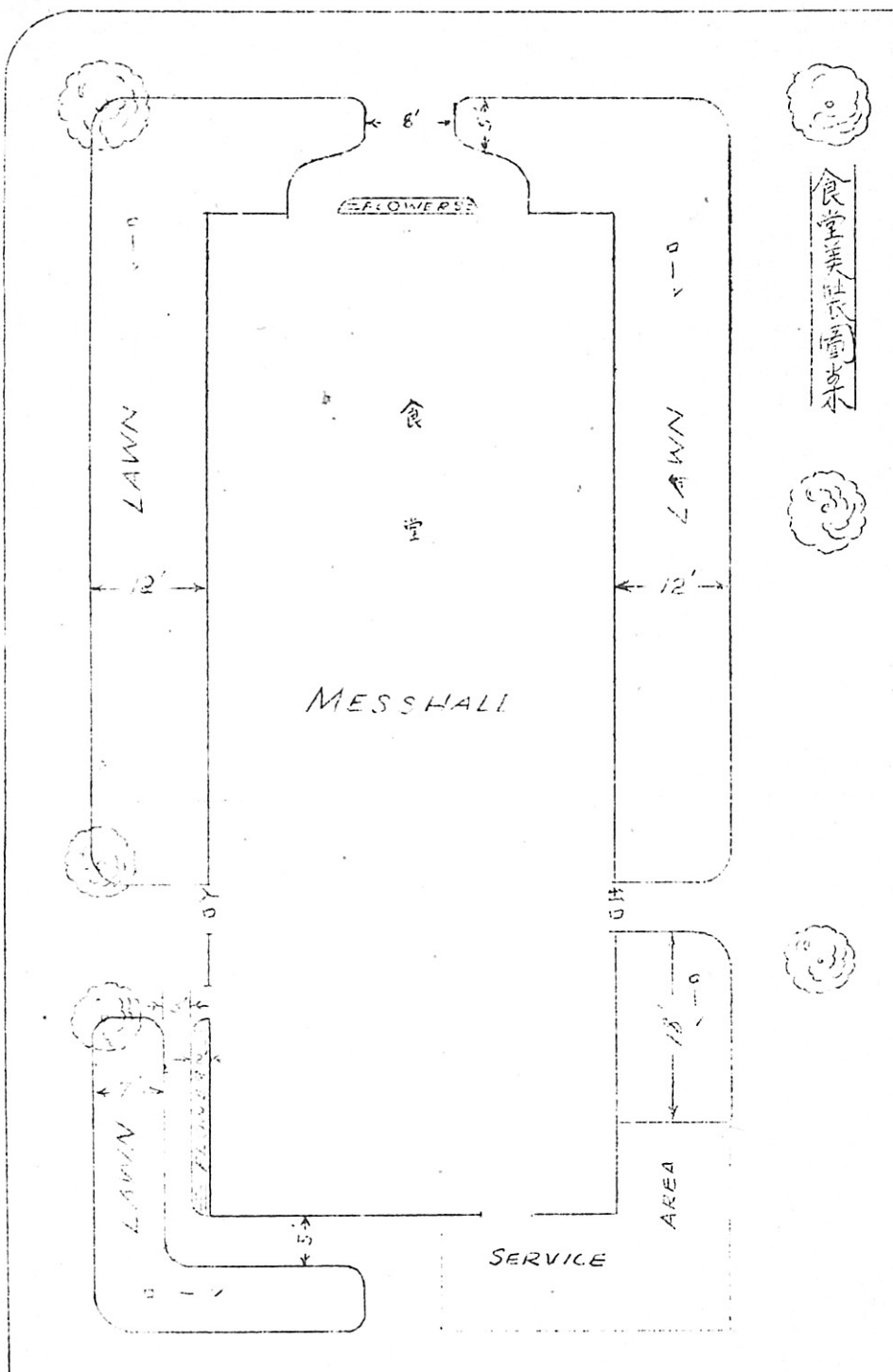

食堂美社管理

食堂

MESS HALL

SERVICE

AREA

Total Lawn Area
25,000 sq. ft.

Seeds required at
1.5 lbs. per 100 sq. ft. =
37.5 pounds of seeds

WAR RELOCATION AUTHORITY		
GILA RIVER PROJECT		
SCALE $\frac{3}{4}" = 10'$	PROPOSED LANDSLIPPING GROUND MESS HALL	
PLANNED	APPROVED	BLOCK NO.
Released Oct. 21, 1948 by M. Nichols, Landscape Engineer from the Canal branch of Gila News-Courier.		

臨時版
一九四二年
十月二十一日
第五號

二戰時日本最大の空襲の一つとして、戦時
空襲警報に響き、べく予備でより建築を急い
でゐたカムフラージ・ネスト工場は、その

一部を既に完成、愈々近く達時を期する事となつた。而して同工場完成の時は加工部、鑄造部互練、切断部一棟、都合六棟、役業員均等に居る大工場となり、設備完了は十一月最初の予定であるが、

監理部では既に活動を開始、同工場従業員は全苛水敷市員たるべしとの前提で下
工員、監理に當り、蓋に當り二百名の
工員を募集して如要する事になった。尚
工部は一名の監督を加へ一組三十三名の
工部は總務一名監督二名以下四十名の

從業員に依り論成 縦四十四呎、幅三十
六呎、縦六十呎、幅三十六呎の二種、刀
工方等、その製造法は、

七十六、也
職掌部
從其官署に於て

てあるを、廣野は「夕葉草」は金魚草と
と云ふ事になつてゐる。工場職人に
てはカムフラージュ、ネット製造の

此様に設計建築されたものであるから、
其奥衛生上の條件を十分に完備しては
ない。一般に信じてゐられてゐるが如き不衛
生な清潔感をもつてはない。従業者の健康
と生活の安全の爲めには、更に設備を整へ

るが、或は部下食堂に就いて食事を、
の協力と確保する事となるであらう。
然し強制的なものは好まぬ。又佐官
の性質上出来る限り従軍せざるを
得る。セーンは女性で、たいに氣持
よくある。

第一館庶專屬職業部
平松宮就任

此二定は、後方から、
 系、
 今後、
 職、
 今、
 山、

造化講習會開設
 九月九日午後三時、第四十八区リクリエーションホールに於て初会合を催す事となしたが、主催側では婦人一般の来会を希望してゐる。

無料ラヂオ修理所開設
 第二監獄猿渡明氏は今回一般の要求に應じて第五十四区八号Aの私室に於てラヂオ修理所を開設する事となす。

本林岡未亡人の感謝
第一館所森岡未亡人は夫の不幸に際して、
第一館所森岡未亡人は夫の不幸に際して、

第二館府無料映画會

第一館府目出度二件

子牧會に於て、大森、飯島、堀江は七月夜半
 八千代、堀江、豊田、飯島に於て冬、結核、
 金、新、活に入つた。