

INFORMATION FOR NEWLY ARRIVED EVACUEES

1. The address of this place is Relocation Branch, McGehee, Arkansas. Each outgoing letter should have as a return address the number of the block, the barrack, and the apartment.
2. A post office is being established in the Center. Mail will be brought from that central post office to the manager of each block. The mail will be distributed from his office.
3. At present the Director of this Center is using temporary headquarters in Block 27, Barrack 1, Apartment A. Other temporary offices are in that vicinity.
4. A temporary field hospital has been established in Block 27, Barrack 12, Apartment A. (One section of the general hospital at the north end of this evacuation town will soon be ready for use.)
5. Each block has a block manager with certain helpers. All personal problems or readjustments as to apartment assignments must be worked out through conference with him.
6. Only the blocks which are occupied by evacuees have been turned over to the War Relocation Authority by the contractors and the United States engineers; and not even these until they are completely finished. Evacuees are at liberty to move freely in these areas only. The military police will give the information regarding the bounds of these regions.
7. The registration and placement officials will presently provide opportunity for everyone in each block to register for work and as nearly as possible in the kind of assignment which he desires and is best fitted for.
8. The management and the construction people are exceedingly anxious that no lumber be taken for family use, like the making of tables and shelves, except from the scrap lumber pile on the corner of the block.
9. Within a day or two school officials and clerks will ask the pupils who are eligible for enrollment in the nursery, grade school, and high school to meet them in the block dining hall for a preliminary enrollment.

Rohwer Ark Relocation Center

Rohwer
Relocation
Center, Desha
County, Ark.
(Layout Plan)

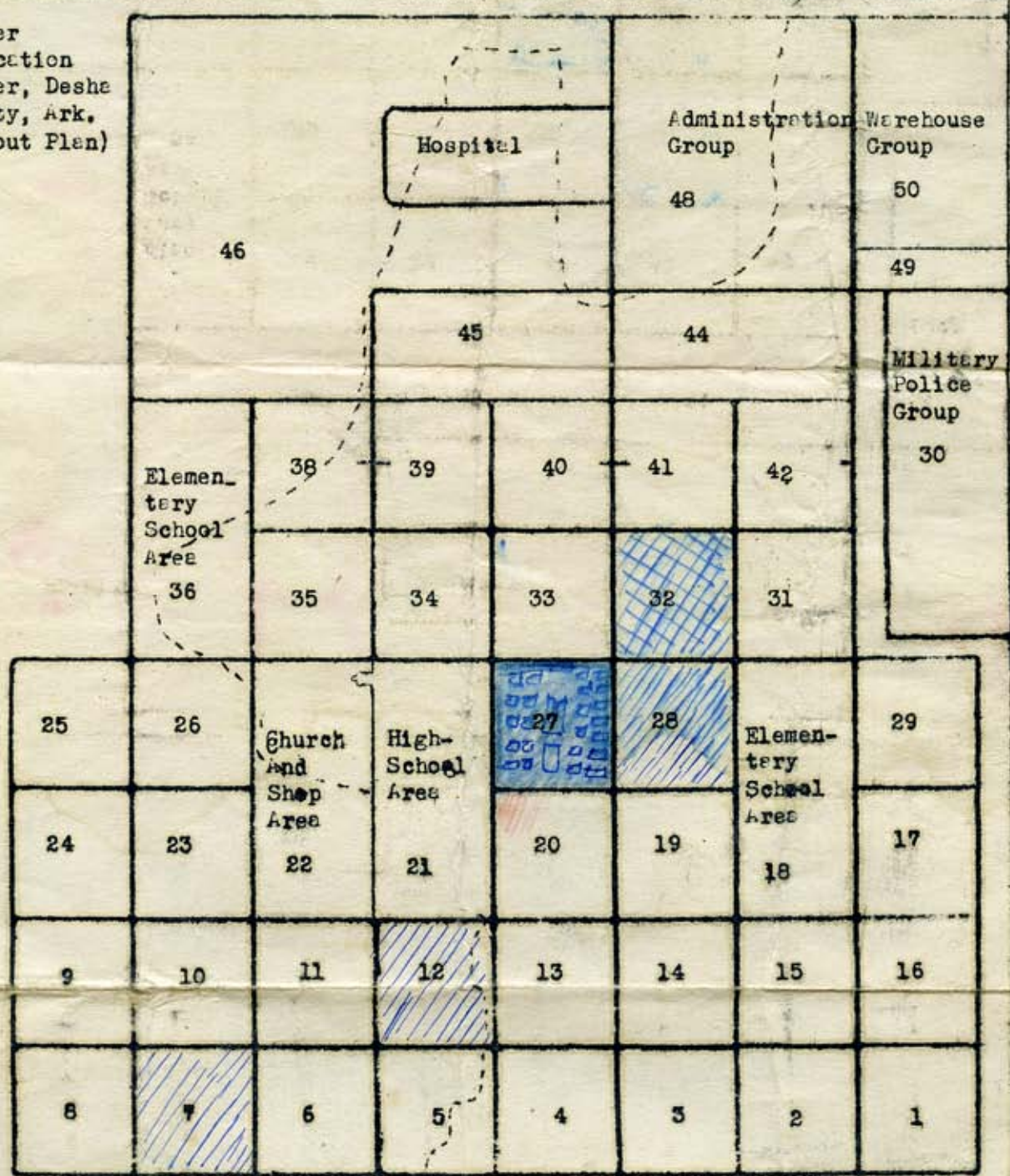

Temporary Offices in Blks. 20, 27.

--- Boundary of Wooded Area