

SHAW-WALKER  
ARCHITECTS  
NEW YORK

-TUMANUMA-  
grandfather **SOKICHI**  
" Mother **CHIYE**

Father **SOTARO** - LATER - SOKICHI.  
Mother **Naka**

DR **TOSHI**  
married  
**ZENTARO**  
**ENDO**  
DR **TAKUO**

**TOMI**  
married  
**UNKICHI**  
**TOWKAIRIN**  
**SOKICHI**  
**TAIZO**

**YEU**  
married  
**TSURUKICHI**  
**KOBAYASHI**

**YEKICHI**  
**SURU**

**IWHIKO**  
married  
**Agnes M. Osbury**  
**ISO**  
**George**  
**ROCKRISE**

married  
June 12, 1949  
**Margaret Paulson**

adopt sister  
**SONO** married  
**TOKAIRIN BUNZABURO**  
**KUNI** married **CHIYA**  
**JISUKE**

SHAW-WALKER  
ARCHITECTS  
NEW YORK

JAPANESE NAME  
IWAHIKO TSUMANUMA  
B. AR. I. J. A. R. A.

CABLE ADDRESS  
"TSUMANUMA, NEW YORK"

THOMAS S. ROCKRISE  
ARCHITECT  
597 FIFTH AVENUE, NEW YORK

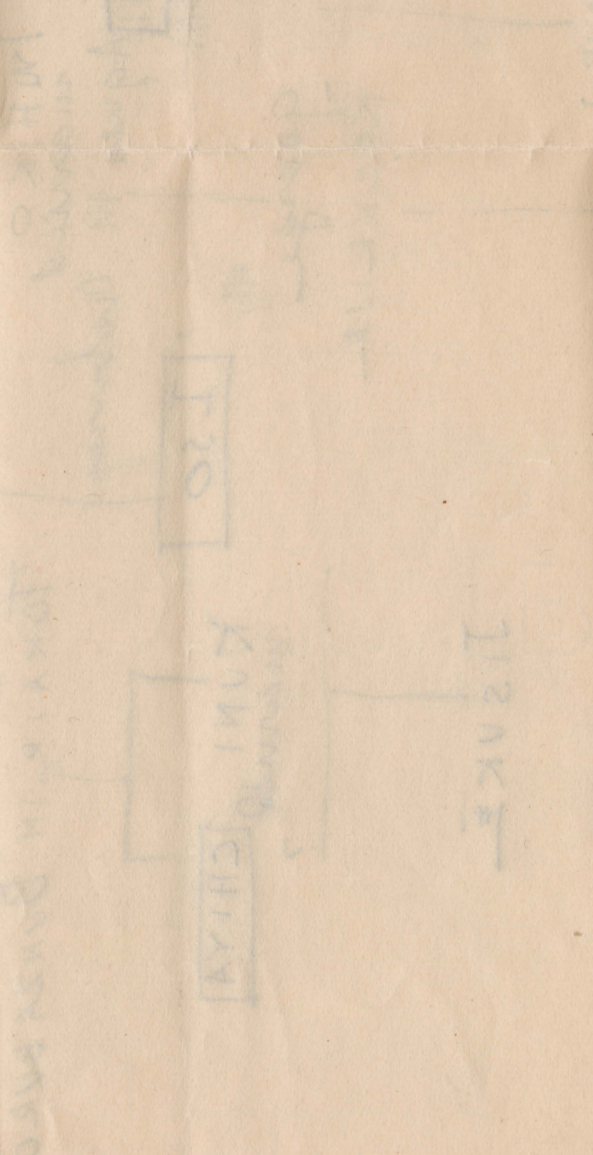
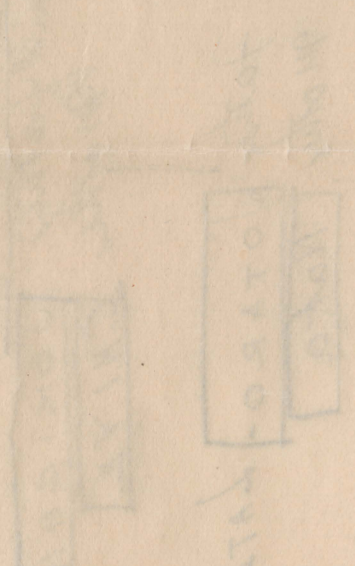
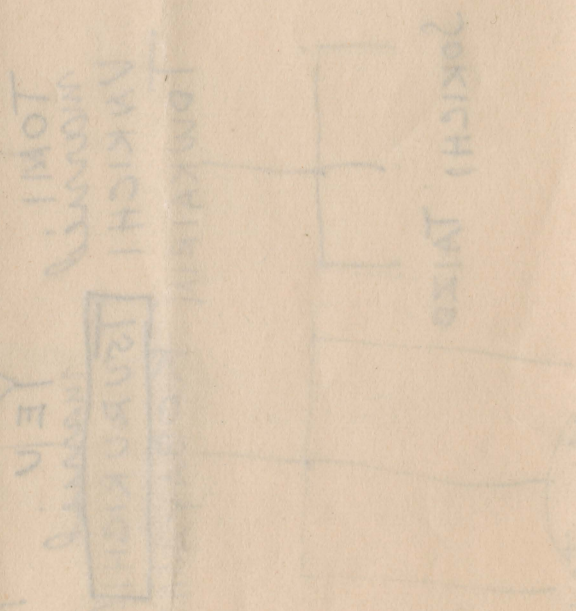

Handwritten notes in Japanese characters, including the date '1911.10.18' and other illegible text.

Family of Isumanuma.

Important.

PHI GAMMA CHAPTER  
DELTA KAPPA EPSILON  
1011 WALNUT AVENUE  
SYRACUSE, NEW YORK