

Please show this to my wife, Tomoye,  
 for she leaves on the first group - the 15th.  
 Box 23, Apt 93-94.  
 Thanks

Sept. 11, 1942  
 Block 15 Bldg. 9, Apt. D  
 Central Utah Relocation  
 Project  
 Topaz, Utah

Dear Tad -

Here is the camp, Tad, in as brief and concise  
 manner as possible. There are <sup>or will be</sup> 36 blocks. Each  
 block contains 1 mess hall, 1 laundry - latrine - showers, 1  
 recreation hall and 12 buildings. Here's a small rough  
 map.

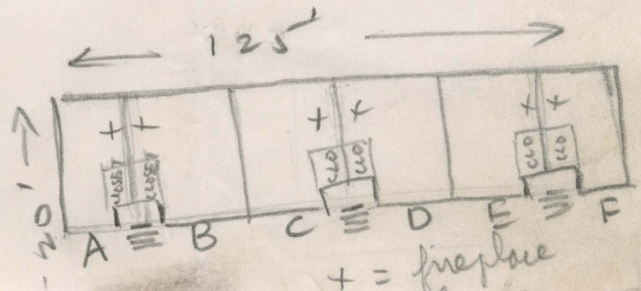
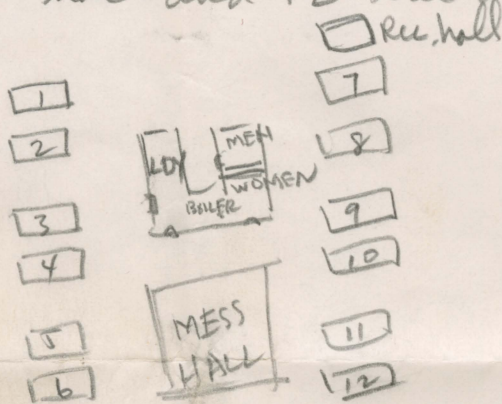

+ = fireplace  
 A and F - for 4 people } we are  
 C and D - for 5 people } trying to  
 B and E - for 6 people } change this  
 from benefit  
 30 people in 1 building,  
 12 buildings in 1 block or  
 360 people in 1 block  
 which is too many.

The buildings are sturdily built with sheet rock on  
 the outside wall over which is tacked some black building  
 paper. They are not completed yet, but we expect the  
 walls to be lined soon. Some cots as Tanfo's are furnished.  
 Also Army blankets, comforters and cotton mattresses.  
 These are of masonite (like Tanfo's shower rooms).  
 Buildings are like those in the infield - but sturdier.  
 There are three well built windows in A + F, 4 in C + D,  
 and 4 in B + E. Closets are provided in each apartment.  
 Only one light so bring your accessories + wires. Ceiling  
 will be soon, we hope.

## II

Provisions are being made for two grammar schools and a high school. There will be "Adult Education" on a community basis, presumably taught at night. Pre-school education will be provided "as needed."

A canteen is to be established, according to a big spot (Caucasian), and others will be supplied as needed.

There will be established a community council, elected by the population and activities guided by the chosen leaders. Numerous enterprises will be added according to necessity.

The camp population will be approximately 10,000 people - perhaps a little over 9,000.

### First impressions:

On the way over - 2 nights on train sleeping sitting up not very good. Dry sagebrush and salty sands of Nevada and Utah did not give us hopes of a pleasant and fertile relocation center.

On arrival - met by a stretch of fine sand (more like silt). The mornings rain fall made the roads muddy. The rooms were full of fine dust - from a wind storm a few days ago which was the worst in "unpten" years. Only vegetation we saw during the 17 mile bus ride from Delta to Topaz (Official Post Office <sup>name</sup> of our camp) were miles of sagebrush dotted by fields of sugar beets, alfalfa, hay, and occasional farm houses.

### III

Showers, bath rooms, latrines, etc. where we are now using are not completed as yet. They are still painting them and putting in the plumbing. But the management (they are very kind and COOPERATIVE) put a wash room into working order with hot water for showers.

Oh yes! The wash rooms are superb! Individual basins for all. Latrines are private for women but not for men. The women's bath room is the best part - they have four REAL BATH TUBS plus showers.

The mess hall is clean and efficient looking - like the main mess at Tanforan. First days meal lunch - consisted of milk, assorted cold meat slices, 1 orange, bread, butter, tea, fresh cabbage & carrot salad.

It rains intermittently so bring your boots. Dress comfortably on train and on arrival. Sandy soil makes walking on high heels very uncomfortable. It is dusty here but not windy yet.

The Administration is wonderful here - very cooperative and kind and willing to please us. It makes us feel so good to be working for understanding people. Rev. Taro Goto is our temporary block manager and he says that it is difficult work. Tanforan managers, attention!

Ford on the train was swell - even better than Tanforan's cooking, which is often times unselectable.

They (no one in particular, just rumors) say that this camp is 5 miles by 7 miles - 35 sq. miles. The buildings will be within 1 sq. mile. Here is the set up, although I might be wrong:

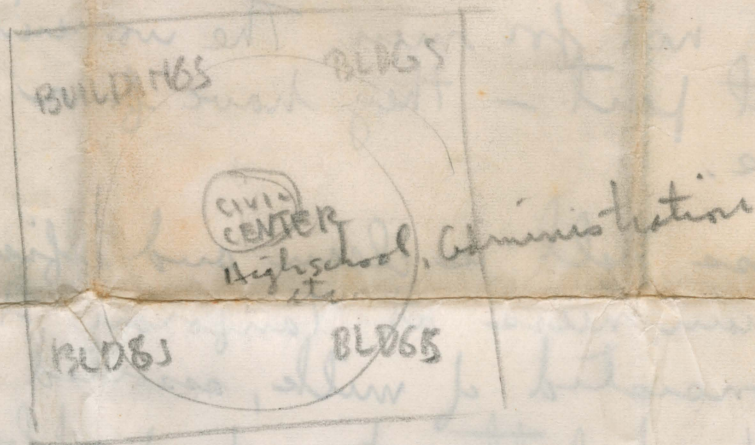

Well, this is about all for now. Am enclosing the first bulletin of this camp which quieted us on our arrival. Sounds better than Tanforan's beginning, doesn't it?

Sincerely,  
Danni

Bob Iki, my room mate, wants this to be shown to his wife, also.

Tommie Takahashi - Bk. 23 Apt. 94