

### THE ALLIED OFFENSIVE IN THE PACIFIC

THE most important fact about the operations in the Solomon Islands is that United States forces are engaged in an offensive operation. The battles of Midway and Coral Sea, as the navy admitted at the time, were defensive victories. In the Solomons American forces are having their first try at one of the most difficult of military operations--the landing of sea-borne troops and the setting up and maintaining of bases for further operations. Any such operation involves heavy risks, and the certainty of considerable losses.

BUT the value of the attack on Tulagi does not lie entirely in the fact that it marks the beginning of an offensive in the Pacific area. In addition to opening the way for further action against Japanese bases in the New Guinea area, it offers needed protection for the United States supply line to Australia. Ever since the Japanese landed troops on New Guinea and New Britain last January, they have moved gradually south and east, creeping ever closer to Port Moresby and to the Australia-United States shipping lanes. Bases were established at Lae, Salamaua and other points on New Guinea, and at Rabaul on New Britain. These and other bases were attacked by American planes as part of the offensive operation.

THE American drive to establish centers on Guadalcanal Island was based on evidence that the enemy was constructing air fields there. Only a few of the Solomon Islands (page 4, col. 1, please)

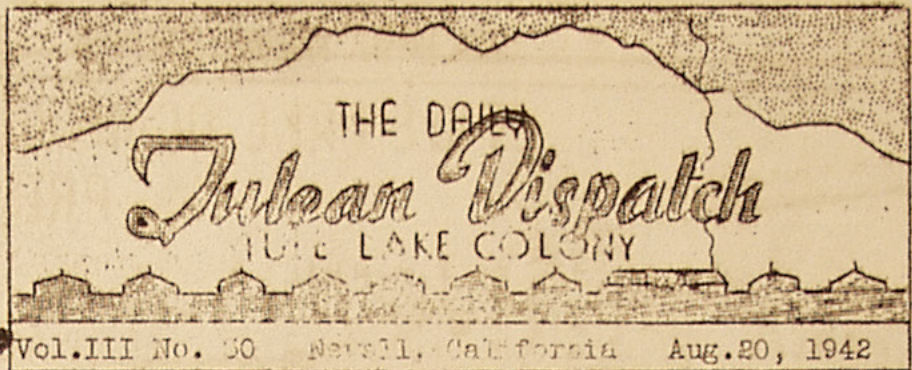

Vol. III No. 30 Newell, California Aug. 20, 1942

## PORTLAND CENTER STARTS MOVE AUG. 29

Plans for the transfer of approximately 3,500 Japanese evacuated from Oregon and Washington military areas to the temporary assembly center at Portland, was announced Aug. 19 by the Army.

The transfer will begin Aug. 29.

Approximately 1,100 Japanese evacuated to the Portland Assembly Center from Benton, Cholan, Kititas, Klickitat, Okanogan and Yakima Counties, Washington, will be transferred to the Heart Mountain Relocation Center, at Vocation, Park County, Wyoming, on the Shoshone River, 13 miles Northwest of Cody. This movement will be completed in about two days.

About 2,400 Japanese evacuated to Portland Assembly Center from the city of Portland, and other portions of Multnomah County, in which Portland is situated, and also portions of Clackamas county, and, all of the

### MORE ARRIVALS DUE NEXT WEEK

That 104 people from Puyallup and 90 from Portland will arrive at Tule Lake was confirmed today. The group will begin arriving sometime next week. A few from other assembly centers are also expected.

### NOTICE

"We expect approximately 104 people from Puyallup next week. All those who expect relatives to come in and have room for them in their apartment, notify the Housing Department so they can arrange proper housing."

Samuel Friedman

counties of Washington, Yamhill, Tillamook, Clatsop, and Columbia, Oregon will be transferred to the Minidoka Relocation Center, Eden, Jerome County, Idaho, 15 miles east of Twin Falls. This movement will begin on or about September 6, and continue at the rate of 600 daily until operation is completed.

About 8,000 evacuees from Camp Harmony, Washington have already begun their trek to Minidoka, Idaho.

### BARGAIN HUNTERS SWARM 4119

Bargain hunting residents swarmed to the fire sale at #4119 early Wednesday morning and within an hour \$1,200 worth of merchandise was sold.

The store opened at 8:30 a.m. and by 9:30 a.m. the customers depleted completely the store's supply of dry goods, groceries, and drugs.

### FLOWER EXHIBIT DRAWS CROWD

Affecting with great pleasure and delight the huge crowds that gathered at #2508 was the flower arrangement exhibit which was held last night. Mr. and Mrs. Cushman, neighboring ranchers donated the many flowers which were arranged by Tatsuo Fujio, adult education flower arrangement teacher.

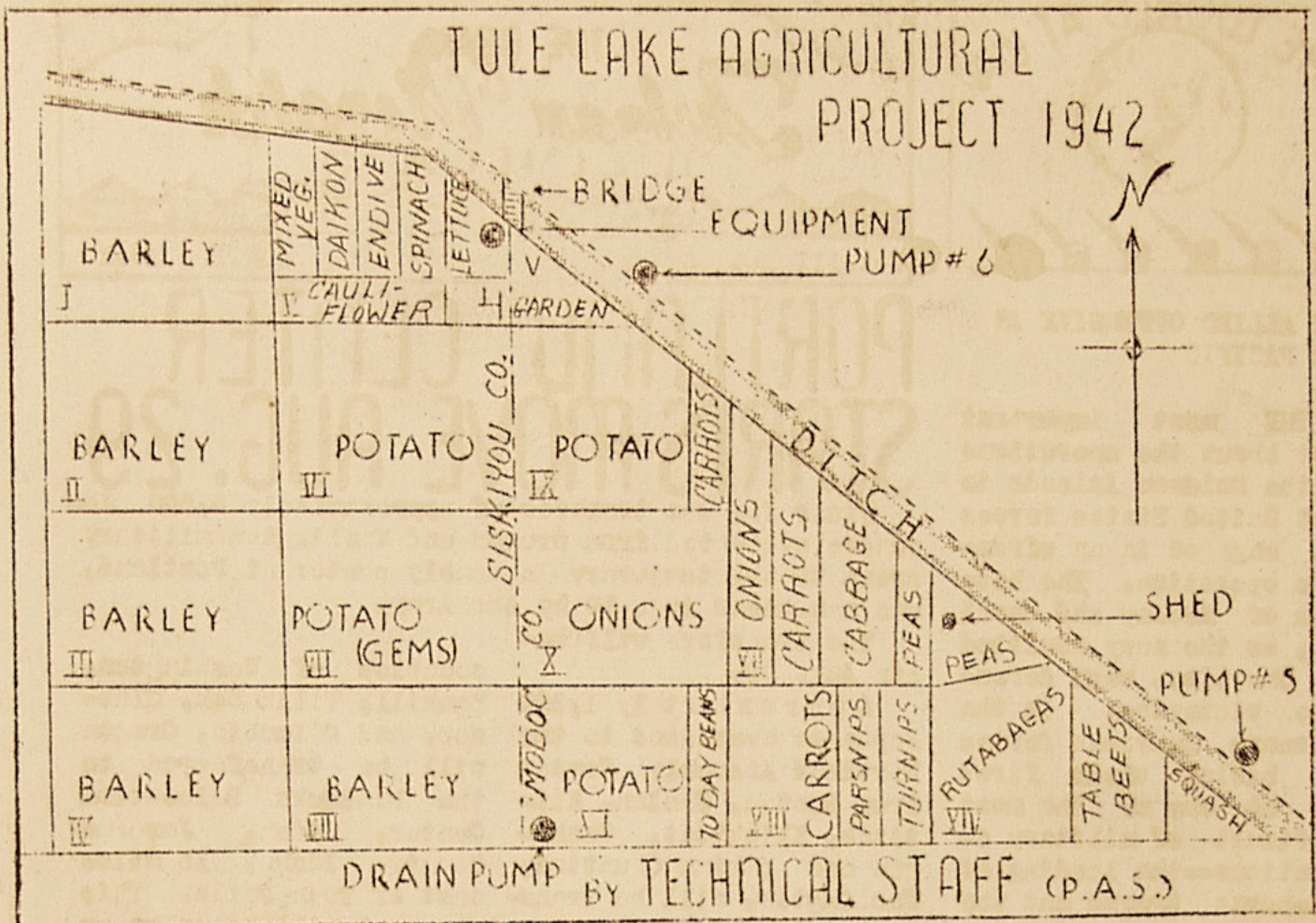

# FROST TERROR WORRIES FARMERS

## 26 KINDS OF VEGETABLES RAISED

CROPS	VARIETY	ACREAGE
Barley	Henschel.....	837.0
Potato	Netted Gems)	
	White Rose )	
	Burbank ).....	571.2
Onions	Soutp. White Globe)	
	Soutp. Y. Globe )	208.2
Carrots	Imperator L. Type)	
	Morse's Bunching )	145.4
Rutabagas	Amer. Purple Top)...	152.5
Cabbage	Penn S. Ball-head...)	57.0
Table Beets	Detroit Dark Red)..	
	Imp. Detrt. Red )..	48.4
Turnips	Purple Top .....	43.6
Pea	Laxton's Progress)	
	Ferry Morse 60 )	38.4
Parsnips	Hallow Crown.....)	27.1
Beans	70 Day Beans.....)	21.4
Cauliflower	Snowball "X". )	
	Danish Ball-head)..	20.0
Spinach	Nobel.....)	19.5
Squash	Y. Smmr. Crookneck)	
	Hubbard )..	16.4
Pumpkin	New England Pie	
	Banana	
Lettuce	Imperial No. 44....)	15.0
Swiss Chard	L. Ribbed D. Green	
Carrot	Supreme Half-Long	
Chnse Cabbage	Wong Bok	
Lettuce	Imperial No. "D"	
Radish	Long Black Spanish)	
	Chnse Rose Winter )	
	Chnse White Winter)	13.3
Mustard	Florida Froad Leaf	
Cucumbers	Snow's Perfection Pickle	
Daikon	Miyashige)	
	Nerima )	
	Tokinashi)	
	Chnse ).....	10.9

With 450 laborers, Tule Lake farm's 2500 acres of black alluvial soil are being tilled to raise various vegetables as "victory food" for the Colony and other relocation centers.

Although the Colony dining halls are supplied with nappa and mustard greens at present by the local farm, the next week will find more vegetables from the farm on the table, such as: peas, spinach, turnips, and beets.

No part of the crop will be sold in the open market, according to the present schedule, but will be consumed here and the surpluses sold to other WRA centers.

The first frost is expected any time this week. The next frost will come after a pleasant period of beautiful Indian summer. Potatoes are the first to be hit by the cold weather, while carrots, cabbages, turnips and rutabagas will survive the longest.

Five thousand acres of cultivation is being anticipated next year, while 32,000 acres of farming is the total acreage expected for the local project.

"W.R.A. is not a research agency," declared E.L. Utz, chief of agricultural production from Washington, before a meeting of technical staff last week. "What we are interested in is good production at reasonable cost," he said emphasizing the cost on the basis of yield.

Endive	Green Curled, ribbed)	
	Broad Loaved Btwn. )	7.6
Colory	Utah )	
	Golden Heart).....	10.0

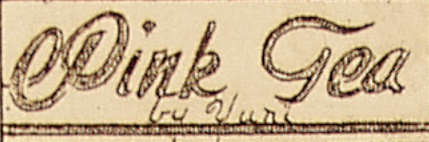

# SKELETON FOUND UNDER BARRACK IN BLOCK 51

## WELL ACQUAINTED NOW

...are approximately 350 persons who attended the Block Manager's "Get Acquainted" dinner party last Thursday night at #2320.

Honor guests for the evening were: Mr. and Mrs. Joe Hayes, Mr. and Mrs. Theodore Waller, Paul Fleming, John D. Cook, Marianne Robinson, Mrs. Francis Throckmorton, Clara Bogorad, Harry Mayeda, Mr. and Mrs. Mac Mafune, Don Elberson and Irvin Hull.

## HONORING THE BIRTHDAY

...of Marjorie Kawasaki, a surprise party was held in her honor Monday evening by the Placement office employees and their friends. The evening was spent playing games and dancing. Riki Matsufuji rendered a solo and Mr. Frank Fagan, chaperone, presented a large box of surprise gifts.

## MUSIC BY ROYAL HAWAIIANS

...highlighted the farewell dance-party Saturday night for Ida Ryugo who left Sunday for Fort Leonard Woods, Missouri. Host and hostess were Mr. and Mrs. K. Ashizawa. About 75 guests were present.

## LUNCHEON GUESTS

...of John D. Cook, head of Information Division, Monday, were E. A. Davis, publisher of the Tule Lake Reporter and his niece, Madi Condon.

## ANTICIPATED

...are more events after the fashion of THE DISPATCH Dansant which was held Sunday evening. Staff members and guests enjoyed, in particular, the drum and trumpet performance during intermission by Bryan Mayeda and Frank Suzuki.

## JUNE CASH ADVANCES

Division: Public Works  
Place: Building #717  
Date: Thursday, Aug. 20  
Time: 7 to 9 p. m.  
Bring payroll identification tags to expedite payment.

While playing under the barrack at #5111, three youngsters unearthed a human skeleton Sunday morning.

Tom Yogo, Jr. #5104-A, Earnest Nomura, #5111-F, and Bill Nakata, #5113-A, were digging a hole under the barrack. A shiny object was uncovered. Thinking it to be a rock, one of the boys picked up the object only to find that he was holding a human skull in his hand.

Terrified, the youngsters crawled out from under the barrack. Curiosity overcame their fear and they returned for further excavation.

More bones were uncovered. These were put inside a carton box and taken to Louis Oki, #51 block manager. He immediately telephoned authorities.

When interviewed by the reporter, the youngsters wanted to know if they were to be rewarded for discovering the skeleton.

"If there's no reward, we ain't gonna dig for anymore," said little Tom Yogo, Jr. "There's some more buried too," he added.

To support his contention he pointed to bits of bones scattered about the ground.

Earnest wanted to know what the authorities were going to do with the bones. When told that the skeletons were to be reconstructed, he said, "You mean they're gonna bring him back to life? You mean they're gonna put the meat back on his bones?"

The block manager has issued instruction prohibiting further digging as there is danger of undermining the barrack foundation.

### CARD OF THANKS

Our sincerest thanks for condolences extended us during our recent bereavement. Mrs. Tsuyo Kaihara and family.

## WARDEN IS A POET:

# KEN YASUDA LISTED IN POETS' "WHO'S WHO"

Ken Yasuda, #5115-B, and formerly of Los Angeles and Seattle is a very extra-ordinary WRA warden.

Yasuda, who matriculated at the University of Southern California and was more lately a senior literature major at the University of Washington volunteered for his present job to kill two birds with one stone. The literary inclined warden whose name appears under the pen name of Ken Bysen in "WHO'S WHO IN AMERICAN POETRY" (1939-41) finds time from his policing duties to compose poems and do other writing.

The nisei poet was at first an assistant teacher of English Poetry here, but this position gave him little time for his real work so he resigned. He then applied for farm labor but was rejected on the grounds that he was not officially terminated

from his first job. His next step was volunteer duty and Yasuda chose the wardens.

At the present time Yasuda is writing a book on "AESTHETIC ANALYSIS OF JAPANESE POETRY" and it is sub-titled "How Japanese Poetry is Possible in English". Prior to the outbreak of the war Yasuda was collaborating with Dr. Lawrence L. Gillman, Professor of English at the University of Washington and well-known author of several books on Keats and a new book on poetry.

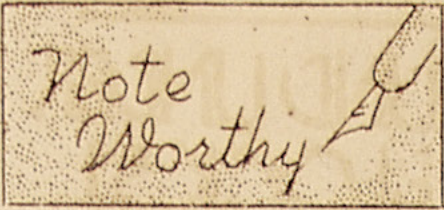

NEW ARRIVAL

...Kosagi Ujiye who arrived Aug. 17 from Bismark N.M.

PHILLIP T. SULLIVAN, ...procurement officer, is leaving for Albuquerque, New Mexico Saturday preparatory to being inducted in the armed forces.

FRANK NAKAMURA, ...#4813-C, was elected the representative to the Community Council by Block #48 upon the resignation of Fred Sakai, #4802-E.

BIBLE STUDY

...with Reverend Daisuke Kitagawa will be held on Wednesday, Aug. 19 from 8 p.m. at #2608.

WATCH THE DISPATCH

...for affidavit dates when a Deputy County clerk will authorize absentee ballots.

DRAFTING STUDENTS

...All those interested in drafting are asked to register this Wednesday and Thursday at #1308. The signup hours are 9 to 11 a.m. and 2 to 4 pm.

PLEASE RETURN

...knitting and crochet instruction books belonging to Kimi Yaka and Mrs. Koyama.

WORLD AT WAR

(Continued from Page 1) are suitable for air bases, and this was an important point in choosing the place of attack.

\*\*\*\*\*

AFTER the Coral Sea battle the Japanese announced that the American fleet was now incapable of offensive action. After the Midway battle we were told that our fleet was annihilated, and after the landings on the Aleutians the Japanese boasted that we could not even protect our Pacific Coast. Now we are being told all over again that nothing remains of the American navy.

\*\*\*\*\*

BUT it still seems to be going places and doing things.

CRUSADERS, AUBURN WIN; A NEW TEAMS SIGN

TRUCKERS, LINCOLN POST VICTORIES

Tacoma Truckers posted their first Class A softball victory Monday evening when they won a narrow 6-5 decision from Block 33. The winning tally was scored in the last half of the seventh on two successive hits.

In an abbreviated four inning tussle Lincoln whipped the Auburn Jrs. 8 to 4.

AMERICAN LEAGUE

While the league-leading Salem Senators have a bye, other American League teams pair off in the next to the final round tonight.

Only the Royal Flushes still have a chance for a tie for the title and their hopes rest on a very slim chance that the Senators get upset by Commerce next Sunday.

- Scheduled games are: Isleton vs. Spark Plug 11, M. Carlo vs. R. Flushes 7, Pick-Ups vs. 49'ers 1, Bears vs. Scrubs 3, Commerce vs. 1400 5, Pensioner vs. Violets 13

Tacoma Crusaders won their second Tule Lake League game Monday by blanking Florin 13 to 0.

The losers were held to three hits and only one man reached third, while the Crusaders collected twelve safe blows.

Table with 4 columns: Team, H, R, and another column. Crusaders 562 0 12 13, Florin 000 0 3 0

Auburn A. C. rallied in the third inning to score six runs and came through with an 8 to 5 win over White River Tuesday.

Table with 4 columns: Team, H, R, and another column. Auburn 006 20 7 8, White River 302 00 4 5

With the entry of Bellevue, Marysville, Has Beens, and Hood River the new Tule Lake Hardball League now has nine teams entered.

Although the schedule was started before they signed up, the new teams will be worked in so that they will play their full share of games.

Has Beens started their season Sunday against Bellevue and came out on the short end of an 8-7 score.

GIRLS' ALLSTAR TEAMS TO PLAY LABOR DAY

An all-star game between the two girls' leagues will feature the Labor Day athletic program.

Both all-star teams will be chosen by the all opponent method. Every girls' team is requested to make a selected team composed of members of opposing teams in their respective leagues. Players with the largest numbers of votes will represent their leagues.

Team managers in both the Western and the Tri-State loops are asked to hand in their selections to Flo Kato at 1808 as soon as possible.

Married women will come into their own on Labor Day when the matron contingents of California and the Northwest will oppose each other.

All attached women are asked to sign up at 1808 at once.